

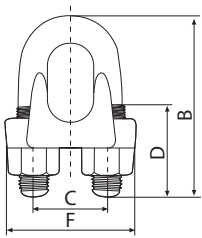

Tusker® Heavy Duty Wire Rope Clamps

Generally to U.S. Fed. Spec. FF-C-450

- Drop forged
- Material: SAE 1035, high tensile steel
- Finish: Hot Dipped galvanised
- Size forged on body

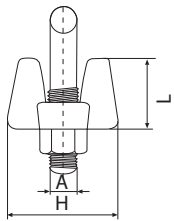

| Product Code | Wire Rope Dia | Bow Dia | Overall Length of Bow | Inside Width | Length of Thread | Length of Base | Thickness of Base | Height of Base | Approx Mass per 100 pce |
|--------------|---------------|---------|-----------------------|--------------|------------------|----------------|-------------------|----------------|-------------------------|
| | | A | B | C | D | F | H | I | in kgs. |
| H14035000 | 3 | 5 | 24 | 12 | 10 | 28 | 22 | 14 | 4 |
| H14035001 | 5 | 6 | 31 | 16 | 11 | 32 | 26 | 16 | 6 |
| H14035002 | 6 | 8 | 34 | 19 | 13 | 37 | 30 | 17 | 8 |
| H14035003 | 8 | 10 | 45 | 22 | 19 | 43 | 33 | 18 | 14 |
| H14035004 | 10 | 11 | 49 | 26 | 19 | 49 | 42 | 23 | 19 |
| H14035005 | 13 | 13 | 51 | 30 | 26 | 58 | 48 | 29 | 34 |
| H14035006 | 16 | 14 | 74 | 33 | 32 | 64 | 52 | 34 | 45 |
| H14035007 | 19 | 16 | 86 | 38 | 37 | 72 | 57 | 36 | 68 |
| H14035008 | 22 | 19 | 98 | 45 | 42 | 80 | 62 | 41 | 108 |
| H14035009 | 25 | 19 | 108 | 48 | 46 | 88 | 67 | 45 | 113 |
| H14035010 | 28 | 19 | 117 | 51 | 51 | 91 | 71 | 48 | 140 |
| H14035011 | 32 | 22 | 130 | 59 | 54 | 105 | 79 | 56 | 207 |
| H14035013 | 38 | 22 | 147 | 66 | 60 | 113 | 87 | 64 | 266 |
| H14035014 | 41 | 26 | 161 | 70 | 67 | 121 | 92 | 67 | 329 |
| H14035015 | 44 | 29 | 175 | 78 | 70 | 134 | 97 | 75 | 441 |
| H14035016 | 50 | 32 | 196 | 86 | 76 | 149 | 113 | 83 | 803 |
| H14035017 | 53 | 32 | 220 | 98 | 81 | 162 | 116 | 100 | 707 |
| H14035018 | 63 | 32 | 227 | 105 | 87 | 168 | 119 | 113 | 806 |
| H14035019 | 69 | 32 | 243 | 112 | 91 | 174 | 127 | 124 | 1000 |
| H14035020 | 75 | 38 | 271 | 121 | 98 | 194 | 135 | 136 | 1440 |

Tusker® Commercial Wire Rope Clamps

Generally to DIN 741

- Material: Mild steel
- Finish: Electro galvanised

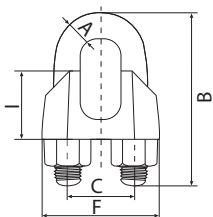
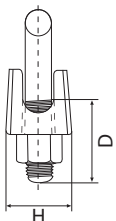

| Product Code | Wire Rope Dia | Bow Dia | Overall Length of Bow | Inside Width | Length of Thread | Length of Base | Thickness of Base | Height of Base | Approx Mass per 100 pce |
|--------------|---------------|---------|-----------------------|--------------|------------------|----------------|-------------------|----------------|-------------------------|
| | | A | B | C | D | F | H | I | in kgs. |
| H14135021 | 3 | 4 | 20 | 9 | 12 | 21 | 10 | 10 | 14 |
| H14135022 | 5 | 5 | 24 | 11 | 13 | 23 | 11 | 10 | 15 |
| H14135023 | 6 | 5 | 28 | 13 | 15 | 26 | 12 | 11 | 21 |
| H14135024 | 8 | 6 | 34 | 16 | 19 | 30 | 14 | 15 | 41 |
| H14135025 | 10 | 8 | 42 | 19 | 22 | 34 | 18 | 17 | 68 |
| H14135026 | 13 | 10 | 55 | 24 | 30 | 42 | 23 | 21 | 130 |
| H14135027 | 16 | 12 | 63 | 29 | 33 | 50 | 26 | 26 | 210 |
| H14135028 | 19 | 12 | 75 | 32 | 38 | 54 | 29 | 30 | 280 |
| H14135029 | 22 | 14 | 85 | 37 | 44 | 61 | 33 | 34 | 400 |
| H14135030 | 24 | 14 | 95 | 41 | 45 | 65 | 35 | 37 | 440 |
| H14135032 | 30 | 16 | 110 | 48 | 50 | 74 | 37 | 43 | 660 |
| H14135034 | 34 | 16 | 120 | 52 | 55 | 80 | 42 | 50 | 850 |
| H14135035 | 36 | 16 | 140 | 58 | 60 | 88 | 45 | 55 | 1040 |

